

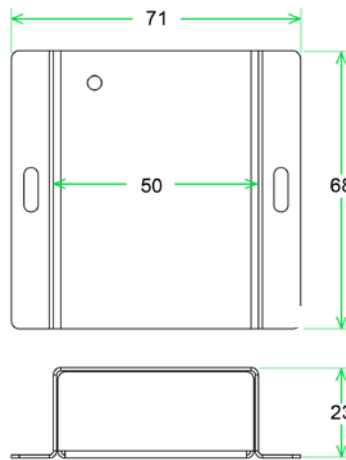

Door Contact Sensor (SEC-DOOR)



General Description

The security door contact is a sensor that is mounted inside racks, cabinets or server room doors. It triggers an alert when the rack door is opened. The sensor directly plugs into the SensorGateway or the Sensorhub. The door contact sensor is a magnetic sensor with a self adhesive or screw mount.

Key Features

- Plugs into the base unit (BASE-WIRED).
- Powered by the base unit (BASE-WIRED).
- Compact plug & play sensor.
- OU rack or wall mountable.
- Steel inclosure. Industrial Grade.
- Alerts via SNMP Traps, email, SMS or voice calls.
- Returns OPEN or CLOSE state
- Magnetic door contact sensor with self-adhesive or screw mount

Technical Specifications

Power Source	SensorGateway (BASE-WIRED)
Power Usage	204 mW
Cable Length	0.15" (0.4m) cable from door contact to probe

Environmental and Physical Specification

Operating temperature range	0°C to +75°C (32°F to +167°F)
Humidity (operating and storage)	< 90% rH (non-condensating).
Dimensions	71 mm (2.8") x 68 mm (2.7") x 23 mm (0.9")
Weight	0.13kg (0.28 lbs.)